

**GARD-DECK TRAFFIC COATING SYSTEM (Unreinforced)**

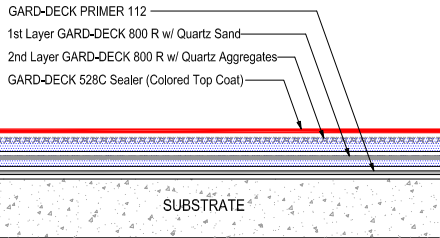

**GARD-DECK TRAFFIC COATING SYSTEM (Reinforced)**

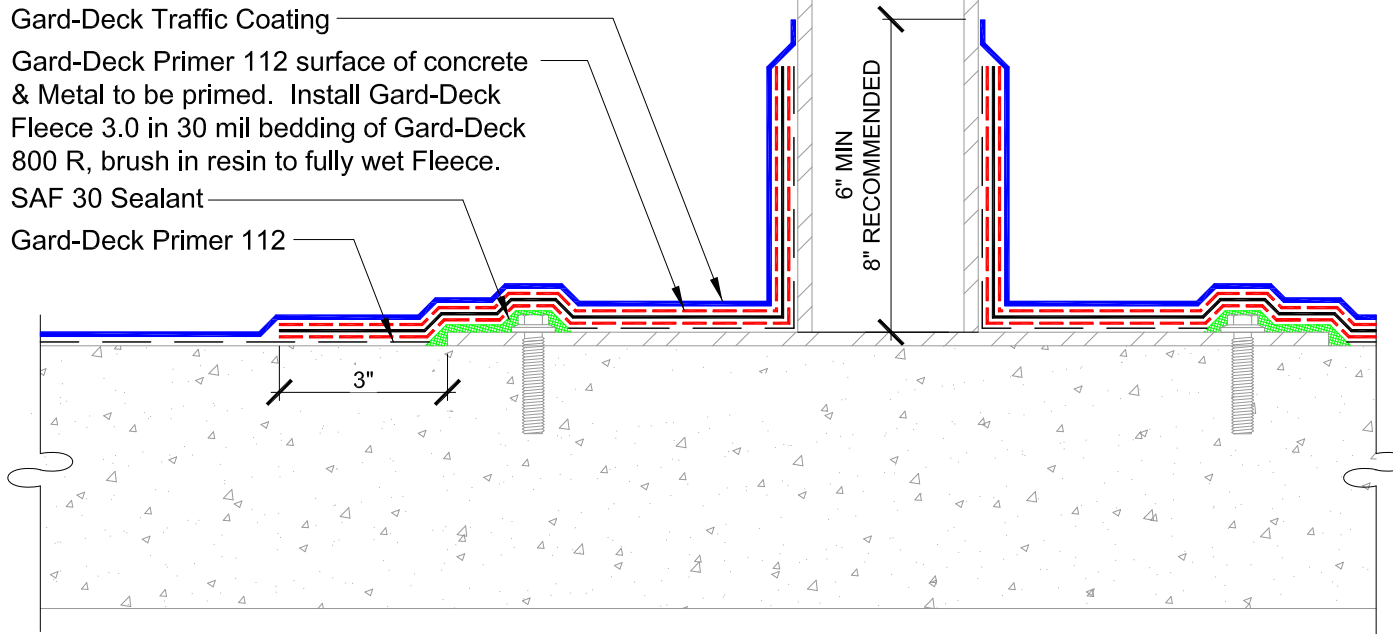
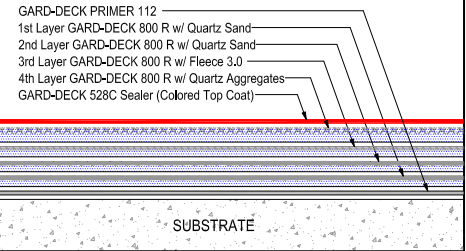

Gard-Deck Traffic Coating  
 Gard-Deck Primer 112 surface of concrete & Metal to be primed. Install Gard-Deck Fleece 3.0 in 30 mil bedding of Gard-Deck 800 R, brush in resin to fully wet Fleece.  
 SAF 30 Sealant  
 Gard-Deck Primer 112



DETAIL NAME:

**STANCHION w/ ANCHORED FOOTPLATE**

JOB NAME:

Scale:

NTS

Date:

04-17-17

Drawing #:

GD-010